

Perimeter Door Frame Seals

RP120



Delta Seal™

RP120 are co-extruded PVC acoustic and smoke seals. Discreetly located in the protected corners of rebated timber or steel door and window frames. RP120 is suitable for new and retrofit applications.

Can be used in conjunction with Raven door bottom seals and astragals and threshold plates.

Location: Around rebated frames of single and double butt hinged doors and windows.

Min/Max Gap: 3mm to 5.5mm.

Fixing: Aggressive self adhesive backing tape on both sides of the carrier.

Note: Contact surface must be clean, smooth and if painted, well cured.

Seal: Black co-extruded rigid and flexible flame retardant PVC.

Sizes: Available in door set sizes.

Approvals

UL Cert. GVV1.R37913.

Acoustic AUS/NZ: NCC Spec. F5.5. UK/EU: Approved Document E. Rated to BS EN ISO 717.1.

Fire AUS/NZ: NCC Spec. C3.4. AS1530.4 & AS/NZS 1905.1. NZ BC Compliance Doc. C/AS1 6.19.2 & App. C6.1.1. UK/EU: Approved Document B. (Tests above are similar to BS EN 1634-1 & BS 476 Pt. 20 & 22).

FRL & FRR -/240/30 and FD240.

Smoke NCC Spec. C3.4. AS1530.7 & BS EN 1634-3. Meets smoke leakage rates specified in AS6905 & EN 13501-2 "Sa", "Sm".

Energy NCC Pt. 3.12.3.3 & J3.4.

RP120

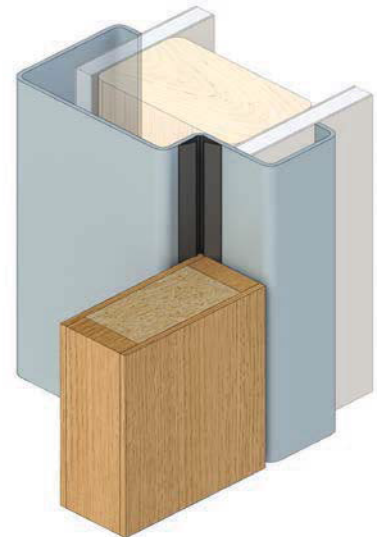
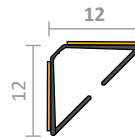

Perimeter Door Frame Seals Self Adhesive

RP48



Location: Perimeter of doors and windows.

Min/Max Gap: 3mm to 5mm (user determined).

Fixing: Self adhesive. Note: Contact surface must be clean, smooth and if painted, well cured.

Seal: White, brown or grey EPDM closed cell sponge.

Sizes: 5m coil pack (2 x 2.5m), jumbo reel (2 x 50m).

Approvals: Energy NCC Pt. 3.12.3.3 & J3.4.



RP48

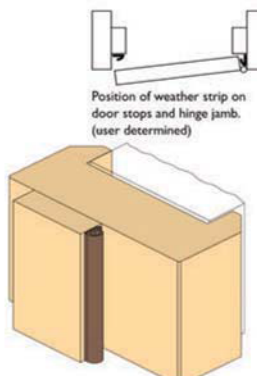
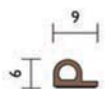

Position of weather strip on door stops and hinge jamb. (user determined)

Perimeter Door Frame Seals Mortised

RP510

Location: Aluminium, PVC or timber door and window frame grooves where dimensions suit.

Compression: 1mm to 2mm.

Finish: White, brown or black.

Fixing: Push-in locking fit into a 3.5mm x 5mm deep kerf groove.

Sizes: 100m, 24m.

Approvals: Acoustic, Weather & Energy.

Optional fitting detail

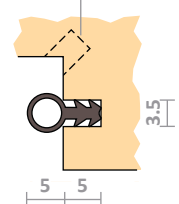

Door Frame Seal with Aluminium Profile

RP78Si



An acoustic medium temperature smoke door frame seal designed for installation on door stops. Its aluminium carrier is sturdy and slotted for adjustment with concealed fixings. It is quick and easy to install around the jamb and head and can be fitted without removing the door. The RP78Si can be mitred or butt jointed for a neat finish.

Can be used in conjunction with the Raven RP8Si, RP16Si, RP35Si, RP38Si, RP99Si, RP126Si, RP127Si or RP128Si automatic door bottom seals.

Location: Head and jambs of single and double butt hinged doors.

Min/Max Gap: 0mm to 6mm.

Finish: Satin clear (silver), bronze anodised aluminium (15µm) or paint at extra cost.

Fixing: Concealed screw fix. Zinc plated, cross recess head S.T. screws, self drilling screws (metal) and cover strip supplied.

Seal: RP394Si. Grey or light grey silicon rubber (SE).

Sizes: Available in door set sizes or stock lengths.

Approvals

UL Cert. GVV1.R37913.

ANSI/BHMA A156.22.

Acoustic AUS/NZ: NCC Spec. F5.5.

UK/EU: Approved Document E. Rated to BS EN ISO 717.1.

Fire AUS/NZ: NCC Spec. C3.4.

AS1530.4 & AS/NZS 1905.1. NZ BC Compliance Doc. C/AS1 6.19.2 & App. C6.1.1.

UK/EU: Approved Document B.

BS 476 Pt. 20 & 22 (similar to BS EN 1634-1).

FRL & FRR-/240/60 and FD240. Gasket flammability index 1 when tested to AS1530.2.

Smoke NCC Spec. C3.4. AS1530.7 & BS EN 1634-3. Meets smoke leakage rates specified in AS6905 & EN 13501-2 "Sa", "Sm".

Energy NCC Pt. 3.12.3.3 & J3.4.

