

RP8Si



A concealed, automatic door bottom seal that is spring loaded to lift clear of the floor when the door is opened. It is acoustically designed, featuring silicon gaskets for medium temperature smoke and fire door applications. Operated automatically by pressure against the door jamb on its adjustable strike. RP8Si can also be fitted into the bottom rail of a metal door by the fabricator. Has a level adjustment to achieve an optimum seal.

Location: Fully morticed into a 15mm x 34mm groove into the bottom of single and double butt hinged timber and metal doors.

Min/Max Gap: 3mm to 13mm.

Finish: Satin clear (silver), bronze or black anodised aluminium (15µm).

Fixing: Concealed screw fix with colour matched stainless steel escutcheon plates and screws supplied.

Seal: RP308Si. Grey silicon rubber (SE).

Sizes: 1220mm, 1070mm, 920mm, 820mm, 600mm, 380mm to 295mm(min). Seals cut back to exact length.

Approvals

Cert. GVYI.R37913

ANSI/BHMA A156.22

Acoustic AUS/NZ: NCC Spec. F5.5.

UK/EU: Approved Document E. Rated to BS EN ISO 717.1.

Fire AUS/NZ: NCC Spec. C3.4.

AS1530.4 & AS/NZS 1905.1. NZ BC Compliance Doc. C/AS1 6.19.2 & App. C6.1.1.

UK/EU: Approved Document B. BS 476 Pt. 20 & 22 (similar to BS EN 1634-1).

FRL & FRR-/240/60 and FD240. Gasket flammability index 1 when tested to AS1530.2.

Smoke NCC Spec. C3.4. AS1530.7 & BS EN 1634-3. Meets smoke leakage rates specified in AS6905 & EN 13501-2 "Sa", "Sm".

Energy NCC Pt. 3.12.3.3 & J3.4.

Design for Access and Mobility High efficiency mechanism to assist with the closing force requirements detailed in AS1428.1.

Durability Tested to over 1,000,000 operating cycles without failure.

Patented.

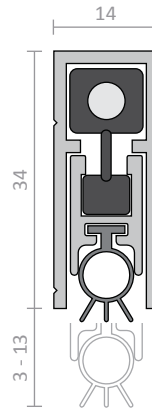

RP99Si



A heavy duty, adjustable, automatic door bottom seal that is spring loaded to lift clear of the floor when the door is opened. Acoustically designed, with a silicon gasket for medium temperature smoke applications. Operated automatically by pressure on the door jamb or stop by its adjustable strike. Includes aluminium cover for concealed fixing for face mounted installation.

Location: Face mounted, semi-morticed or fully morticed into single and double solid core butt hinged doors. Can be fitted into the bottom rail of metal doors by the fabricator. Minimum door thickness of 40mm for semi and fully morticed installations. For double door fully morticed installations, plain meeting s les required.

Min/Max Gap: 3mm to 19mm.

Finish: Satin clear (silver), bronze anodised aluminium (15µm) or paint at extra cost.

Fixing: Concealed screw fix. Zinc plated, cross recess head S.T. screws supplied. Colour matched escutcheon plates and face mount aluminium angle included.

Seal: RP347Si. Black silicon rubber (SE).

Sizes: 1220mm, 1070mm, 920mm, 820mm, 720mm, 600mm, 380mm to 295mm(min). Seals cut back to exact size.

Approvals

Cert. GVYI.R37913

Acoustic AUS/NZ: NCC Spec. F5.5.

UK/EU: Approved Document E. Rated to BS EN ISO 717.1.

Fire AUS/NZ: NCC Spec. C3.4. AS1530.4 & AS/NZS 1905.1. NZ BC Compliance Doc. C/AS1 6.19.2 & App. C6.1.1.

UK/EU: Approved Document B. BS 476 Pt. 20 & 22 (similar to BS EN 1634-1).

FRL & FRR-/240/60 and FD240. Gasket flammability index 1 when tested to AS1530.2.

Smoke NCC Spec. C3.4. AS1530.7 & BS EN 1634-3. Meets smoke leakage rates specified in AS6905 & EN 13501-2 "Sa", "Sm".

Energy NCC Pt. 3.12.3.3 & J3.4.

Design for Access and Mobility High efficiency mechanism to assist with the closing force requirements detailed in AS1428.1.

Durability Tested to over 1,000,000 operating cycles without failure.

Patented.

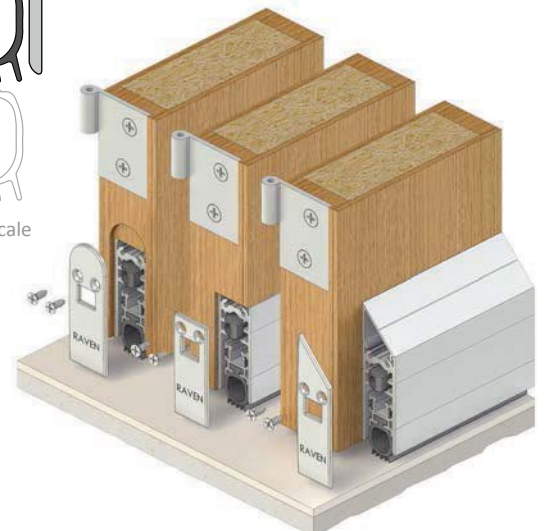
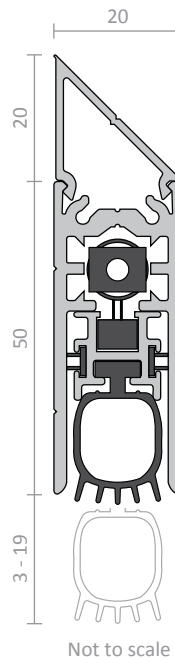

Door Bottom Seal

RP51Si



A heavy duty silicon rubber sweep seal for the bottom of outward opening doors. RP51Si has slotted fixing holes for adjustment with a push-in cover strip for concealed fixing.

The RP51Si is ideal for use in conjunction with Raven threshold plates.

Location: Bottom of single and double, outward opening, butt hinged doors, tilt up doors or can be used as an astragal seal.

Min/Max Gap: 5mm to 20mm (user determined).

Finish: Satin clear (silver), bronze anodised aluminium (15µm) or paint at extra cost

Fixing: Concealed screw fix. Zinc plated, cross recess head S.T. screws and cover strip supplied. Fixing holes are pre-slotted.

Seal: RP351Si. Grey silicon rubber (SE).

Sizes: Available in stock lengths.

Approvals

Fire & Smoke AUS/NZ: NCC Spec. C3.4. AS1530.4 & AS/NZS 1905.1. NZ BC Compliance Doc. C/AS1 6.19.2 & App. C6.1.1.

UK/EU: Approved Document B. BS 476 Pt. 20 & 22 (similar to BS EN 1634-1).

FRL & FRR-/120/30 and FD120. Gasket flammability index 1 when tested to AS1530.2.

Energy NCC Pt. 3.12.3.3 & J3.4.

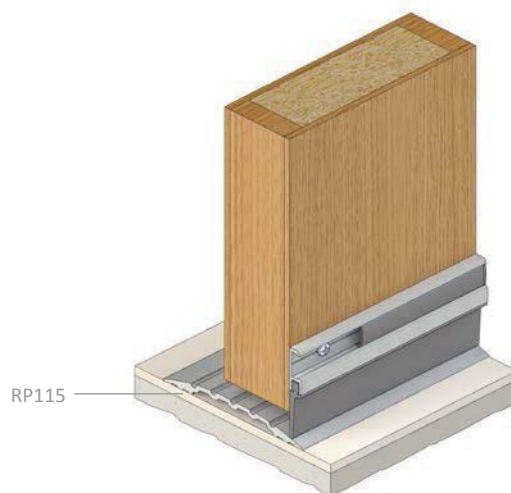
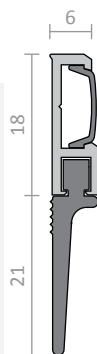

Brush Strip Seals

Nylon Filament

RP2a



A nylon brush strip seal with an anodised aluminium carrier that mounts to the inside or outside of a door. It is ideal for sliding or double acting doors.

Can be concealed inside of an aluminium door suite bottom rail by the fabricator.

Used in conjunction with Raven threshold plates.

Location: Bottom of single, double, sliding and double acting doors.

Min/Max Gap: Up to 19mm (user determined).

Finish: Satin clear (silver), bronze anodised aluminium (15µm) or paint at extra cost

Fixing: Self adhesive or can be screw fixed. Note: Contact surface must be clean, smooth and if painted, well cured.

Seal: Black fine, dense, UV stabilised nylon filaments.

Sizes: Available in stock lengths.

Approvals

Energy NCC Pt. 3.12.3.3 & J3.4.

BAL ≤FZ when used on a garage in accordance with AS 3959.

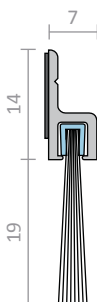

RP2



Nylon brush strip seals without holder, that are fitted in a concealed manner into a machined groove in a door.

Where a small clearance is encountered, the groove should be double morticed to allow the brush to flex.

Location: Stiles or bottom of single, double, sliding and double acting timber doors.

Min/Max Gap:

RP2 up to 19mm (user determined).

Fixing: Inserted into morticed groove (optional adhesive if required). Where a small clearance is encountered, the groove should be double morticed to allow the brush to flex.

Seal: Black fine, dense, UV stabilised nylon filaments secured in a galvanised steel spine.

Sizes: Available 1000mm length Standard
Please chek with us for other available length.

Approvals

Energy NCC Pt. 3.12.3.3 & J3.4.

RP2

