

MA80 - Straight sliding door on aluminum track

TRACK	
11145	Aluminium track. Available in 5m, 3m and 2m.

GEAR	
MA80	Set including : 2 hangers (with ball bearings) 2 stops 2 plates 10036 1 guide 1103 R screws and assembly instructions

ACCESSORIES	
2529	Reinforced angle plate for wall-fixing of the track, supplied with screws, nut and washer. Height=23mm, Length=30mm, Thickness 30/10
11213 S80	hydraulic door closer stop for doors up to 80 KG (MA 80)
M66	Damper closer system for gentle closing of doors (over 100mm). Damper automatically follow to its closed position.



Track, hanger & plate assembly with standard stop



MA80 gear



11145



2529



11213 S80



M66

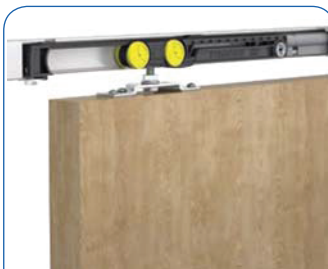

Installed with M66 Damper closer



Installed with 11213 S80

Fixing on wall with 2529 bracket

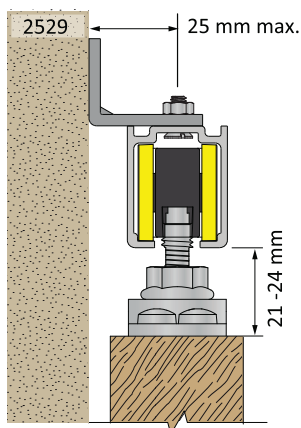

Fixing on the ceiling

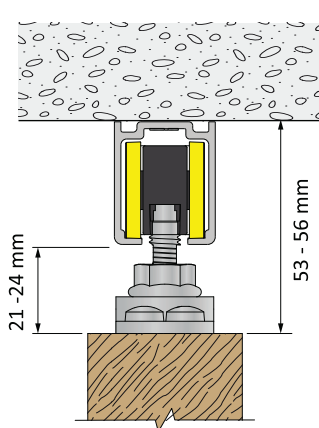

Guides 1103R

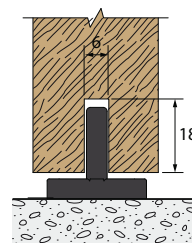

Sliding Door System

Straight sliding door 120kg

Fortress Land Door Hardware

SAF 120 - Straight sliding door on aluminum track 120kg doors

TRACK	
11312	Aluminium track. Available in 5m, 3m and 2m.
GEAR	
SAF 120A	Gear for doors up to 120kg including : 2 rollers (with ball bearings & polyamide wheels) 2 adjustable stops 2 plates 10036 1 guide 1103 R 1 spanner, screws and assembly instructions
OPTIONAL ACCESSORIES	
11031	Alu-anodized pelmet to click on track 11312 for ceiling fixing. Available in 3 meter.
11041	Alu-anodized pelmet, to clip on track 11312 for wall fixing. Available in 3 meter.
11045	Set of end caps for 11041 pelmet (single track)
11013	Sliding angle plate for a wall fixing of the track
11036	Flush mounting bracket

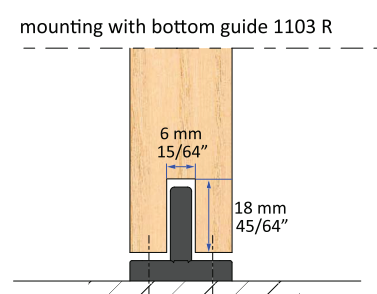
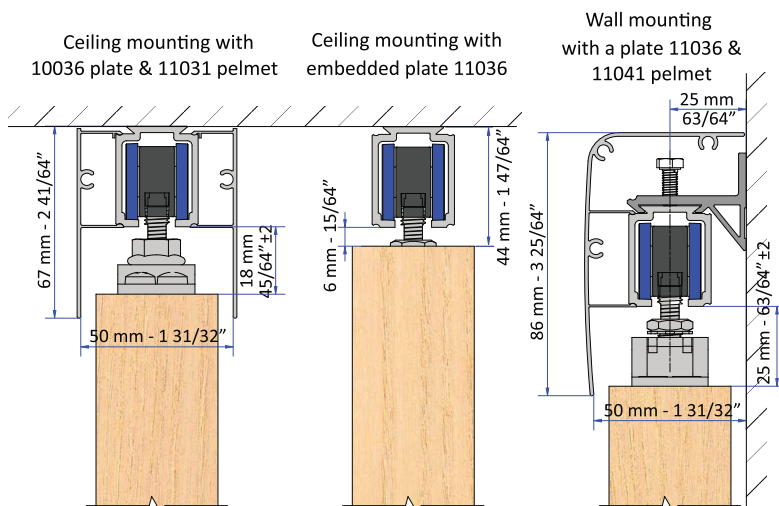
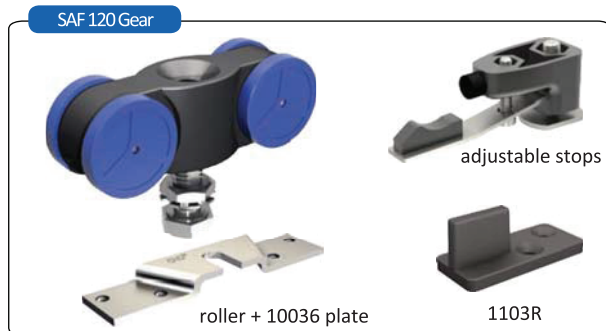

Sliding Door System

Straight Sliding 600kg - 2000kg

Fortress Land Door Hardware

Sliding Door 600kg - 2000kg

Track	
8570	Galvanised track 85 x 70mm (standard: 5m) Up to 2,000kg doors.

Rollers Hanger & accessories (600kg)	
2285	Hanger, top fixing, 4 wheels with ball bearings, nylon tyre and glass fiber. Fixing bolt ØM16 (1pc only. Please order 2 pcs to make a set)
0086	Plate, screwing type for top fixing ØM16
0086W	U-Plate, screwing type for top fixing ØM16

Bottom Guides	
1115	U-profile 50x60mm, galvanised. Available in 6m and 3m.
1059	Bottom guide with olive (equipped with needle roller bearings) fixed on a screwing type plate (with square ends) - for U-profile 50x60mm

