

KEY CYLINDERS

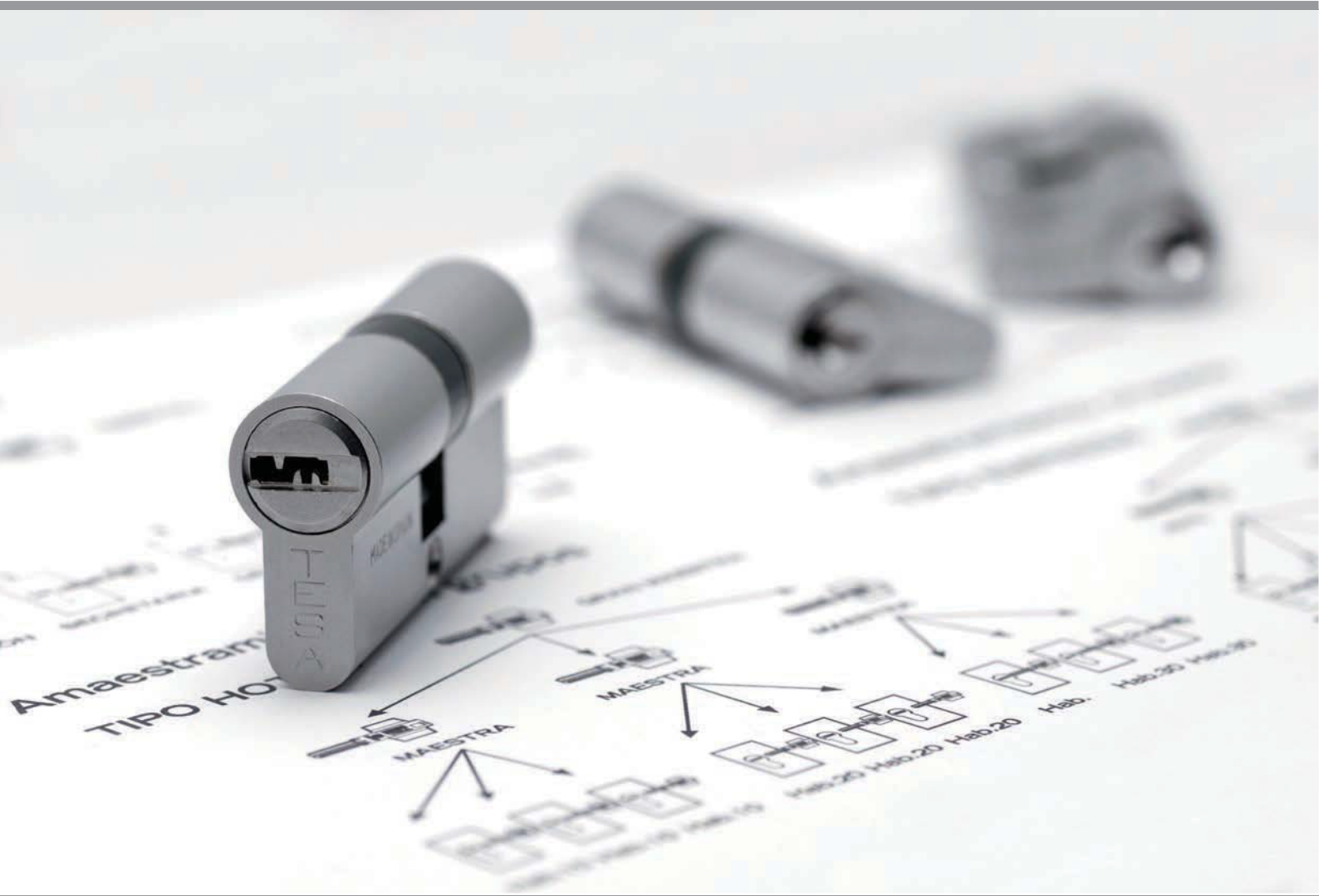

TESA Cylinders



ASSA ABLOY



A wide range

Key systems are classified according to four standards:

- Type of key (dimple or sawn)
- Restricted Key
- Degree of security
- Masterkeying capacity

The combination of such standards has created a peerless range in the market, covering every requisite in projects ranging from the residential to the institutional, from cost-efficient technical systems to high security patented systems.



Guaranteed and Standard Certificates

TESA cylinders meet the most demanding EU standards for architectural fittings, in which cylinders are very important components in terms of protection and personal safety.

Specially EN1303 European standard establishes five degrees of security (Fire resistance, security against breakage, number of combinations, durability and corrosion resistance) for cylinders, based on design requisites and on practice tests simulating an attack.

The DIN standard specifies which standards must be met by cylinders in order to obtain mastering certification. Others standards and certifications met by TESA's cylinders are UL (USA), NEN (Holland) and SS (Sweden)

Security

From the most basic to the highest security patented, restricted-key models, our cylinders have been equipped with the most advanced protection systems; spring loaded pins, antiremoval system, etc.. Our restricted key systems guarantee that no blank keys will be found in the market, thus ensuring protection against counterfeit keys.



Masterkeying capacity

All TESA cylinders can be master keyed. A masterkeying is a planned locking system in which the master key can open more than one cylinder, even if each cylinder has it's own key. For offices, residential homes and plans of various sizes, masterkeying is the immediate solution that allows to establish an access control while reducing the number of keys that must be handled: security and comfort.



TESA Cylinders Features

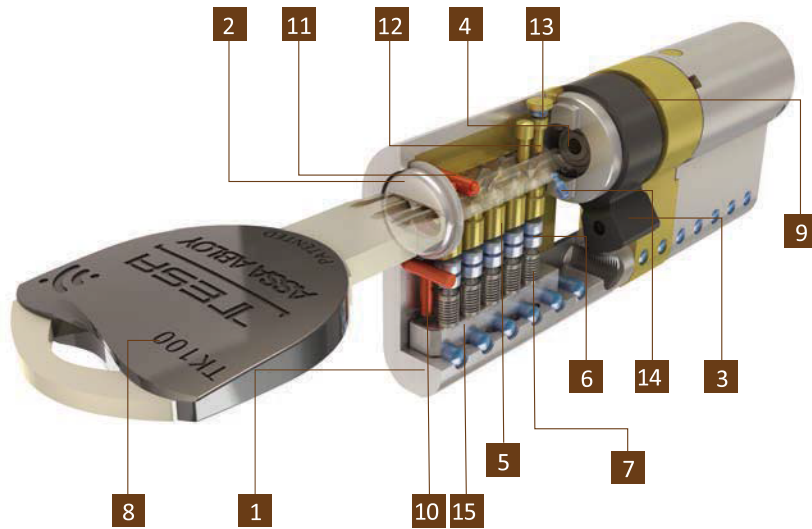

Glossory

1. BARREL or BODY: The frame that supports the whole assembly.

2. PLUG: the main element that forms the cylinder's transmission which sends the rotating motion from the key to the cam.

3. CAM: which operates the lock. It may come in various size depending on the manufacturing or design of the lock. 2 types of cams: 15mm radius for wooden doors and 13.2mm radius for narrow profile lockcase (aluminium and PVC doors)

4. CLUTCH: the parts that allows the user to monitor the side that sends motion from the key to the cam. A version of the clutch exists that allows the user to open from the outside in case the key is inserted from the inside. This is called 'DS Clutch = Doble sentido', both directions).

5. LOWER PIN (main row): The part that determines the combination in a specific cylinder. It will condition the depth of puncturing that a correct key must have.

6. UPPER PIN (main row): complements the lower pin and allows for the blocking of specific key combinations.

7. SPRING: it loads the pin and makes it possible to bring it back.

8. KEY: Correct key allows users to open the door.

9. CLIPS: secure the whole assembly.

10. ANTIDRILL BODY PIN: provides security in case of antidrill tampering.

11. ANTIDRILL ROTOR PIN: protects the rotor from drilling attempt.

12. LOWER PIN (second row): same function as main row.

13. UPPER PIN (second row): same function as main row.

14. LOWER PIN (third row): Radial distribution. It usually belongs to the system's patent.

15. CAPS: keeps the pin loaded (lower and upper pin, spring).

Recommended Selection Criteria

- **Key Type:** either "Sawn" or "Dimple"
- **Security level:** determines the performance of the cylinder against different unauthorized opening methods.
- **Profile:** refers to the shape of the cylinder and depends on the type of lockset.
- **Finish:** options on "Brass" or "nickel".
- **Measurement:** depends on the door thickness.
- **Function:** specify the way operating with the key.
From both sides (double cylinder)
One side (single cylinder)
One side key and thumb turn the other (cylinder & thumbturn).
- **Type of Cam:** it will determined by the type lockset (lock for wooden doors, PVC doors, narrow profile doors..etc...).
- **Format:** key to differ, key alike and master keyed system.

Key System Summary Chart

System	TK100	TK6	T70	T60
Key	Patented	Patented	Patented	-
Type	Dimple	Sawn	Dimple	-
Security Level	*****	****	*****	**
Master Keying Capability	*****	****	-	*

TESA Cylinders Overview

T60 system - Standard Cylinder

- Nickel - plated brass key.
- 6 spring-loaded pins.
- 5 keys per cylinder
- Antibump system
- Antidrill protection
- Certified to EN1303:2005 standard

Security	Masterkeying
**	-

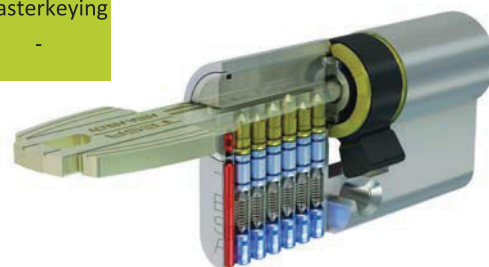

T70 system - Security Cylinder

- Patented, non-duplicable key.
- 6 spring-loaded pins.
- 5 non-duplicable, cylinder-patented keys.
- Antibump system
- Double antisnap protection.
- Antiextraction system DEGREE2.
- Narrow neck on the key.
- Certified to EN1303:2005 standard.
- Protected key copies available only by presenting the propriety card.

Security	Masterkeying
***	-
***	-

NEW

ANTI-COPY SYSTEM
PATENTED



TK6 system - High Security Cylinder

- Patented, non-duplicable key.
- 6+1 spring-loaded antipick pins.
- Antidrill tempered steel pins in the body and the rotar.
- Antibump system
- 3 patented protected keys in standard package.
- Certified to EN1303:2005 standard.
- Protected key copies available only by presenting the propriety card.

Security	Masterkeying
***	**
**	**

ANTI-COPY SYSTEM
PATENTED



TK100 system - High Security Cylinder

- Patented, non-duplicable key with SENSOR system. Compatible with RFID technology (optional)
- 5+5 pins with multiple-tip tear shaped section. (Exclusive TESA technology)
- Anti-milling pins on rotor front.
- Hard-metal antidrill pins in the body and the rotor
- Build in escutcheon / antiextraction rotor
- Advanced antibump.
- The bridge has been reinforced with a steel bar. Maximum degree according to the applicable laws.
- Double clutch as standard.
- 5 patented. protected keys.
- Certified to EN1303:2005 standard.
- Protected key copies available only by presenting the propriety card.

Security	Masterkeying
****	****
****	****

ANTI-COPY SYSTEM
PATENTED

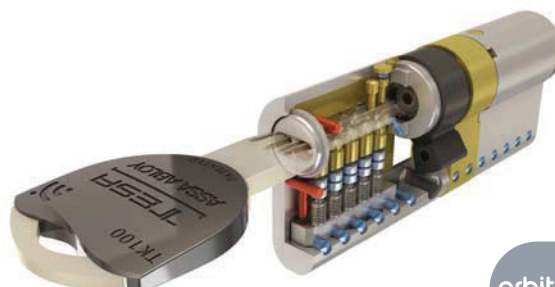

T60 Cylinder

Technical data

It is a reversible dimple key system which covers basic security levels.

Security **	Masterkeying -
----------------	-------------------

Characteristics

- » Type: Dimple key. (Brass nickel plated).
- » Number of rows: 1
- » Number of pins: 6
- » Combination level: Grade 5
- » Technology: Tumbler regular.
- » Corrosion resistance: Grade B.
- » Anti pick system.
- » Drill resistant.
- » Bump proof cylinder lock.
- » Lifespan: 100,000 test cycles.
- » 3 / 5 keys per cylinder.
- » Conform to EN-1303 regulation



Options

- » Double security clutch.
- » Modular. (For unusual measures o anti snap protection)
- » Cams: DIN R15, R13 and different pinion gears.
- » Finishes: Brass / Nickel plated.
- » Formats available: Key different, mater keyed, key alike and specific codes.
- » Wide size and profile range.

European standard regulation.

T60 is certified according to the standard EN 1303 regulation, getting the following results.

1	6	0	1	0	B	5	0
Key resistance (Grade 0-1)	Lifespan (Grade 4-6)	Door mass (Not applied in cylinder)	Fire resistance (Grade 0-1)	Safety of the people (Not applied in cylinders)	Corrosion and temperature resistance (Grade 0-A-B-C)	Key related security (Grade 1 to 6)	Attack resistance (Grade 0 to 2)

Masterkey systems

The platform that supports its manufacturing makes it possible to combine a maximum number of 7 heights per position. The T60 is a suitable system for Masterkey systems where complexity levels are not too high.

ONLY AVAILABLE FOR ADDITIONS

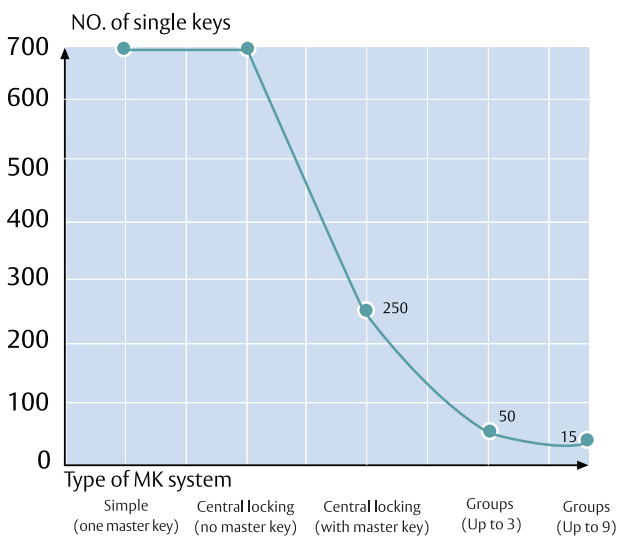

Recommendations

- » Use TESA lubricant to lengthen the maximum lifespan of the cylinder.
- » Use original keys to make copies.
- » For safety reasons, when you select a new cylinder, remember that once installed, it should not project more than 1mm.



T60 Cylinder



T60 Cylinder - Double with Thumbturn

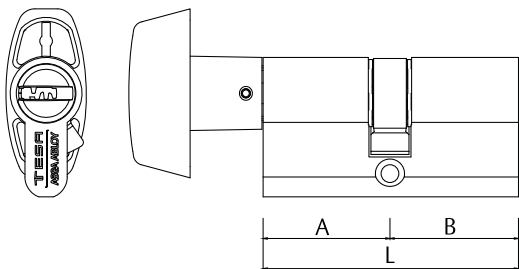

CODE	Description	Finish	L	A	B
T63B3030L	Dou. Thumbt. 60mm	Brass	60mm	30mm	30mm
T63B3030N	Dou. Thumbt. 60mm	Nickel	60mm	30mm	30mm
Note: Also available in different dimensions for different door thickness.					
Please call Fortress Land for additional info.					

T60 Cylinder - Double Cylinder

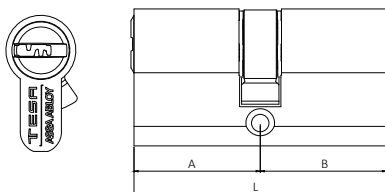

CODE	Description	Finish	L	A	B
T6353030L	Double 60mm	Brass	60	30	30
T6353030N	Double 60mm	Nickel	60	30	30
Note: Also available in different dimensions for different door thickness.					
Please call Fortress Land for additional info.					

T70 Anti-Snap Cylinder



Technical details

The T70 cylinder has been specially designed to provide a guaranteed solution against SNAP attacks, while also providing efficient anti-extraction, anti-bump and anti-drill protection. The (patented) head of the key presents a special configuration that makes it compatible with NARROW HEAD escutcheons. The cylinder's security is also supported by a patent, ensuring that the key can not be duplicated.

Features

Basic

- » Type of key: Flat, non-duplicable and patented.
- » Number of rows: 1
- » Number of pins: 6+1 security sensor in the cylinder.
- » Combinatory: Degree 5
- » Resistance to corrosion and temperature: Degree B
- » Durability: 100,000 cycles

Anti-Tampering Protection

- » Double ANTI-SNAP protection:
 - via fuse slot
 - via reinforced steel bar
- » ANTIBUMP system
- » Anti-pick protection
- » Anti-drill protection: DEGREE 2
- » Anti-extraction protection: DEGREE 2

Narrow Head

- » Special configuration of the (patented) head of the key. Compatible with narrow-profile escutcheons.

Key protection

- » Patented key and cylinder.
- » Key duplication and cylinders are protected by property card.

Certification

- » Certificated according to EN1303

Options

- » Brass and nickel-chromed finishes
- » Cams: R15 and R13.
- » Optional: cylinders in KD and key alike. Not available in master keying.
- » Europrofile range, padlock and 682 and adjustable round shape.

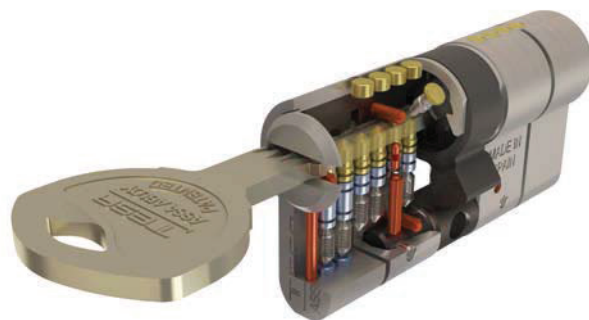

Regulations

As well as the main models featured in TESA's catalogue, the T70 has been certified according to tests specified by European standards.

1	6	0	1	0	B	5	2
Resistance of the key (Degree 0-1)	Durability (Degree 4 to 6)	Door mass and locking force (Not applicable for cylinders)	Apt for use with firebreak doors (Degree 0-1)	Personal safety (Not applicable for cylinders)	High resistance to corrosion and temperature (Degrees 0, A, B, C)	Security of the key (Degree 1 to 6)	Anti-tampering resistance (Degree 0 to 2)

Recommendations

- » Use TESA lubrication for an optimum service life of the cylinder.
- » Always keep the ownership card in order to make copies of the keys.
- » Follow the mounting instructions supplied with the cylinder for the correct mounting of the product.



T70 Anti-Snap Security Cylinder

Patented

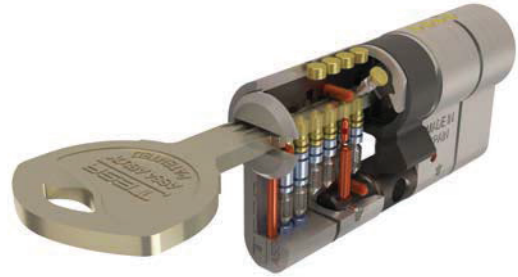

T70 Cylinder - Double with Thumbturn

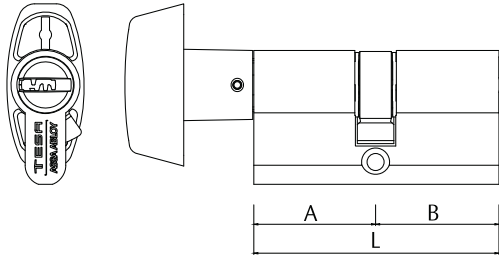

CODE	Description	Finish	L	A	B
T75B3030L	Dou. Thumbt. 60mm	Brass	60mm	30mm	30mm
T75B3030N	Dou. Thumbt. 60mm	Nickel	60mm	30mm	30mm
Note: Also available in different dimensions for different door thickness.					
Please call Fortress Land for additional info.					

T70 Cylinder - Double Cylinder

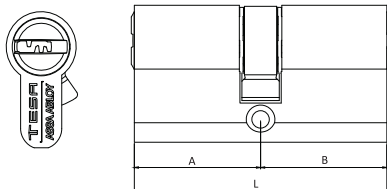

CODE	Description	Finish	L	A	B
T7553030L	Double 60mm	Brass	60mm	30mm	30mm
T7553030N	Double 60mm	Nickel	60mm	30mm	30mm
Note: Also available in different dimensions for different door thickness.					
Please call Fortress Land for additional info.					

T70 Cylinder - Single Cylinder

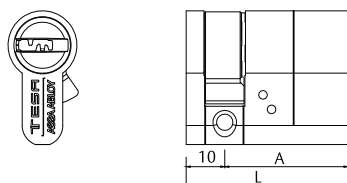

CODE	Description	Finish	L	A	B
T7553010N	Half 30 /10 cylinder	Nickel	40mm	30mm	-
Note: Also available in different dimensions for different door thickness.					
Please call Fortress Land for additional info.					

TESA High security cylinder TK6

Technical data

New model designed to cover two basic necessities in the market. On the one hand has been made with an exclusive and patented combination technology to solve complex master key suites and on the other hand a new security sensor lets the owner control all the keys in one installation.

Security *** **	Masterkeying ** **
-----------------------	--------------------------



Characteristics

- » Type: Patented sawn key with security sensor.
- » Number of rows: 1
- » Number of pins: 6.
- » Technology: DROP ORBITAL (Exclusive TESA rights)
- » Permutation level: Grade 6.
- » Corrosion resistance: Grade B
- » Anti pick cylinder lock (High resistance.)
- » Bump proof system.
- » Drill protection grade 1.
- » 3 patented keys made of nickel silver.
- » Conform to EN-1303 regulation.
- » Lifespan: 100,000 test cycles.
- » Master key systems: Medium capability in combination with DROP ORBITAL platform.

European standard regulation

In the same way as the main models included in the catalogue, the TK6 is certified according to the European standard regulation.

	1	6	0	1	0	B	6	0
Key resistance (Grade 0-1)								
Lifespan (Grade 4-6)								
Door mass (Not applied in cylinder)								
Fire resistance (Grade 0-1)								
Safety of the people (Not applied in cylinders)								
Corrosion and temperature resistance (Grade 0-A-B-C)								
Key related security (Grade 1 to 6)								
Attack resistance (Grade 0 to 2)								

Options

- » Finishes: Brass / Nickel.
- » Cam: DIN R15 and R13
- » Formats available: Key different, mater keyed, key alike and specific codes.
- » A wide range of sizes and profiles.
- » Colour points to differentiate master key levels.

*Note; with the shield E700 the attack resistance rise to the level 2.

Master key system

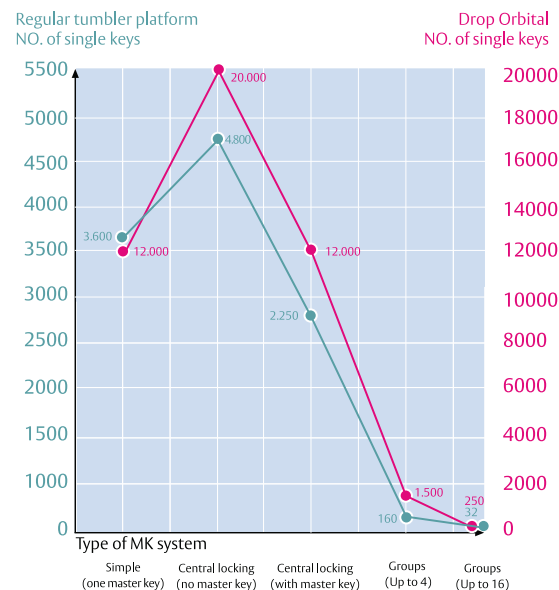

Recommendations

- » Use TESA lubricant to lengthen the maximum lifespan of the cylinder.
- » TESA recommends to the user of the TK6 to keep the property card in a safe and secure location. Only by presenting this card, can one obtain key and cylinder copies.
- » For safety reasons, when you install a new cylinder, remember that once installed, it should not project more than 1mm.



Project Order Only

High security cylinder TK6

Patented

Project Order Only



European profile

Double Cylinder

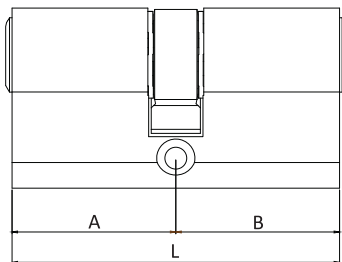

L	A	B	Cam = 15 mm	Finish	Short cam Cam = 13,2 mm	Finish
60	30	30	AK635 30 30 L	Brass	AK63M 30 30 N	Nickel
65	30	35	AK635 30 35 L	Brass	AK63M 30 35 N	Nickel
70	30	40	AK635 30 40 L	Brass	AK63M 30 40 N	Nickel
70	35	35	AK635 35 35 L	Brass	AK63M 35 35 N	Nickel
75	30	45	AK635 30 45 L	Brass	AK63M 30 45 N	Nickel
75	35	40	AK635 35 40 L	Brass	AK63M 35 40 N	Nickel
80	30	50	AK635 30 50 L	Brass	AK63M 30 50 N	Nickel
80	35	45	AK635 35 45 L	Brass	AK63M 35 45 N	Nickel
80	40	40	AK635 40 40 L	Brass	AK63M 40 40 N	Nickel
85	35	50	AK635 35 50 L	Brass	AK63M 35 50 N	Nickel
90	30	60	AK635 30 60 L	Brass	AK63M 30 60 N	Nickel
90	35	55	AK635 35 55 L	Brass	AK63M 35 55 N	Nickel
90	40	50	AK635 40 50 L	Brass	AK63M 40 50 N	Nickel
90	45	45	AK635 45 45 L	Brass	AK63M 45 45 N	Nickel
100	30	70	AK635 30 70 L	Brass	AK63M 30 70 N	Nickel
100	40	60	AK635 40 60 L	Brass	AK63M 40 60 N	Nickel
100	50	50	AK635 50 50 L	Brass	AK63M 50 50 N	Nickel
110	30	80	AK635 30 80 L	Brass	AK63M 30 80 N	Nickel
110	50	60	AK635 50 60 L	Brass	AK63M 50 60 N	Nickel
120	30	90	AK635 30 90 L	Brass	AK63M 30 90 N	Nickel
120	40	80	AK635 40 80 L	Brass	AK63M 40 80 N	Nickel
120	60	60	AK635 60 60 L	Brass	AK63M 60 60 N	Nickel
130	30	100	AK635 31 00 L	Brass	AK63M 31 00 N	Nickel
140	40	100	AK635 41 00 L	Brass	AK63M 41 00 N	Nickel
150	50	100	AK635 51 00 L	Brass	AK63M 51 00 N	Nickel
160	60	100	AK635 61 00 L	Brass	AK63M 61 00 N	Nickel

Single Cylinder

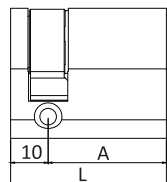

L	A	B	Cam = 15 mm	Finish	Cam = 13,2 mm	Finish
40	30	10	AK635 30 10 L	Brass	AK63M 30 10 N	Nickel
45	35	10	AK635 35 10 L	Brass	AK63M 35 10 N	Nickel
50	40	10	AK635 40 10 L	Brass	AK63M 40 10 N	Nickel
60	50	10	AK635 50 10 L	Brass	AK63M 50 10 N	Nickel
70	60	10	AK635 60 10 L	Brass	AK63M 60 10 N	Nickel
80	70	10	AK635 70 10 L	Brass	AK63M 70 10 N	Nickel
90	80	10	AK635 80 10 L	Brass	AK63M 80 10 N	Nickel
100	90	10	AK635 90 10 L	Brass	AK63M 90 10 N	Nickel

Double with Thumbturn

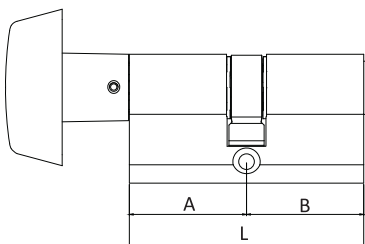

L	A	B	Cam = 15 mm	Finish	Cam = 13,2 mm	Finish
60	30	30	AK63B 30 30 L	Brass	AK63MB 30 30 N	Nickel
65	30	35	AK63B 30 35 L	Brass	AK63MB 30 35 N	Nickel
70	35	35	AK63B 35 35 L	Brass	AK63MB 35 35 N	Nickel
70	40	30	AK63B 40 30 L	Brass	AK63MB 40 30 N	Nickel
80	30	50	AK63B 30 50 L	Brass	AK63MB 30 50 N	Nickel
80	40	40	AK63B 40 40 L	Brass	AK63MB 40 40 N	Nickel
85	35	50	AK63B 35 50 L	Brass	AK63MB 35 50 N	Nickel
90	30	60	AK63B 30 60 L	Brass	AK63MB 30 60 N	Nickel
90	45	45	AK63B 45 45 L	Brass	AK63MB 45 45 N	Nickel

TK100 - High Security Cylinders

Technical data

TK100 cylinders have been designed with the most exclusive protection systems. This newly version integrates, in addition of the patent, an exclusive orbit combination system which fully surpass the maximum key security grade specified in the standard regulation. In addition to that, this new manufacturing concept improves against non destructives opening methods such as bumping, picking...etc. To complete the maximum security grade in all its extension, this model incorporates extra protections to resist the most usual attacks applied when breaking in.

In terms of drill protections, TK100, in addition of incorporating hardened pins, includes a new protector shield integrated. With this new cylinder, TESA starts a new gait which lead the future in all the cylinder range.

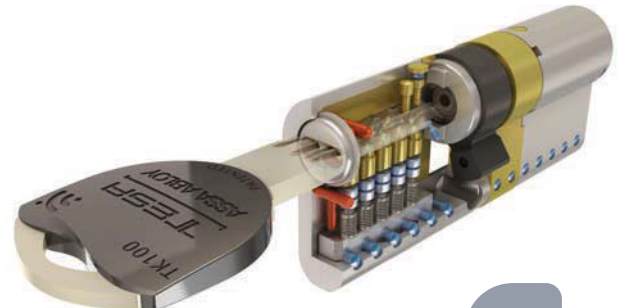

Features

- » Type of key: Flat, non-duplicable and patented.
- » Number of rows : 2
- » Number of pins: 10 + 2 security sensors in the key.
- » Technology: DROP ORBITAL (TESA Exclusive)
- » Combinatory: It reaches way above the degree 6 of the standard.
- » Masterkey systems: Superior capacity with no need to use passive pins.
- » Resistance to corrosion and temperature: Degree C
- » Advanced antibump.
- » Top antipick protection.
- » Antipick protection way above the maximum degree specified by the European standard.
- » Antiextraction rotor.
- » Corona pins on rotor front.
- » The bridge of the body features preinstalled reinforced steel.
- » Resistance: 200,000 cycles.
- » Preinstalled double-security clutch.
- » 5 narrow-neck keys per cylinder.
- » New, ergonomic key design.
- » Key duplication and cylinders are protected via ownership card.
- » Certified according to the EN 1303 standard.

Options

- » Finishes: Brass / Nickel.
- » Cam: DIN R15 and R13.
- » Formats available: Key different, mater keyed, key alike and specific codes.
- » A wide range of sizes and profiles.
- » Colour points to differentiate master key levels.

Master key systems

The new orbit permutation system TESA has patented gives TK100 the highest level of security ever seen in the market. For that reason, TK100 is de ideal system for master keyed requi - rements. It does not matter how complex the master keying is. TK100 will solve, widely, every type of lock charts.

European standard regulation

TK100 widely surpass the different laboratory tests specified in the standard European regulation.

	1	6	0	1	0	C	6	2
Key resistance (Grade 0-1)								
Lifespan (Grade 4-6)								
Door mass (Not applied in cylinder)								
Fire resistance (Grade 0-1)								
Safety of the people (Not applied in cylinders)								
Corrosion and temperature resistance (Grade 0-A-B-C)								
Key related security (Grade 1 to 6)								
Attack resistance (Grade 0 to 2)								

Recommendations.

- » Use TESA lubricant to lengthen the maximum lifespan of the cylinder.
- » TESA recomends to the user of the TK100 to keep the property card in a safe and secure location. Only by presenting this card, can one obtain key and cylinder copies.
- » For safety reasons, when you install a new cylinder, remember that once installed, it should not project more than 1mm.





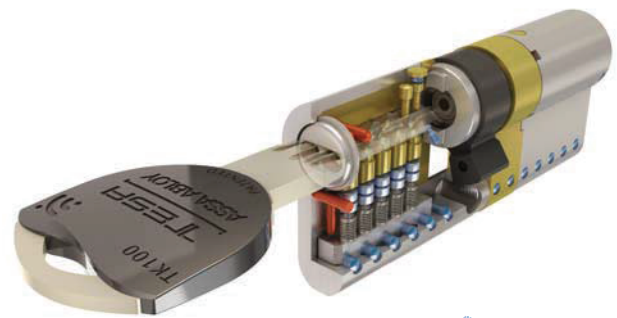

TK100 High Security Cylinders

Patented

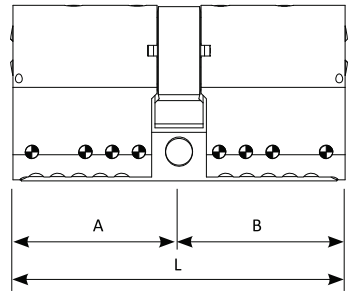
Project Order Only

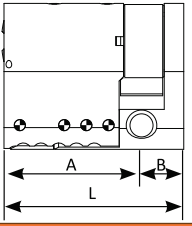

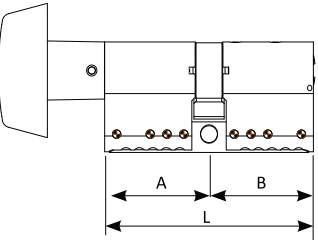
Double european		L	A	B	Cam = 15 mm	Finish	Short cam Cam = 13,2 mm	Finish
		60	30	30	TK15 30 30 L	Brass	MK15 30 30 N	Nickel
		65	30	35	TK15 30 35 L	Brass	MK15 30 35 N	Nickel
		70	30	40	TK15 30 40 L	Brass	MK15 30 40 N	Nickel
		70	35	35	TK15 35 35 L	Brass	MK15 35 35 N	Nickel
		75	30	45	TK15 30 45 L	Brass	MK15 30 45 N	Nickel
		75	35	40	TK15 35 40 L	Brass	MK15 35 40 N	Nickel
		80	30	50	TK15 30 50 L	Brass	MK15 30 50 N	Nickel
		80	35	45	TK15 35 45 L	Brass	MK15 35 45 N	Nickel
		80	40	40	TK15 40 40 L	Brass	MK15 40 40 N	Nickel
		85	35	50	TK15 35 50 L	Brass	MK15 35 50 N	Nickel
		90	30	60	TK15 30 60 L	Brass	MK15 30 60 N	Nickel
		90	35	55	TK15 35 55 L	Brass	MK15 35 55 N	Nickel
		90	40	50	TK15 40 50 L	Brass	MK15 40 50 N	Nickel
		90	45	45	TK15 45 45 L	Brass	MK15 45 45 N	Nickel
		100	30	70	TK15 30 70 L	Brass	MK15 30 70 N	Nickel
		100	40	60	TK15 40 60 L	Brass	MK15 40 60 N	Nickel
		100	50	50	TK15 50 50 L	Brass	MK15 50 50 N	Nickel
		110	30	80	TK15 30 80 L	Brass	MK15 30 80 N	Nickel
		110	50	60	TK15 50 60 L	Brass	MK15 50 60 N	Nickel
		120	30	90	TK15 30 90 L	Brass	MK15 30 90 N	Nickel
		120	40	80	TK15 40 80 L	Brass	MK15 40 80 N	Nickel
		120	60	60	TK15 60 60 L	Brass	MK15 60 60 N	Nickel
		130	30	100	TK15 31 00 L	Brass	MK15 31 00 N	Nickel
		140	40	100	TK15 41 00 L	Brass	MK15 41 00 N	Nickel
		150	50	100	TK15 51 00 L	Brass	MK15 51 00 N	Nickel
		160	60	100	TK15 61 00 L	Brass	MK15 61 00 N	Nickel
Single european. (8 positions standard)		L	A	B	Cam = 15 mm	Finish	Cam = 13,2 mm	Finish
		40	30	10	TK15 30 10 L	Brass	MK15 30 10 N	Nickel
		45	35	10	TK15 35 10 L	Brass	MK15 35 10 N	Nickel
		50	40	10	TK15 40 10 L	Brass	MK15 40 10 N	Nickel
		60	50	10	TK15 50 10 L	Brass	MK15 50 10 N	Nickel
		70	60	10	TK15 60 10 L	Brass	MK15 60 10 N	Nickel
		80	70	10	TK15 70 10 L	Brass	MK15 70 10 N	Nickel
		90	80	10	TK15 80 10 L	Brass	MK15 80 10 N	Nickel
		100	90	10	TK15 90 10 L	Brass	MK15 90 10 N	Nickel
Knob european.		L	A	B	Cam = 15 mm	Finish	Cam = 13,2 mm	Finish
		60	30	30	TK1B 30 30 L	Brass	MK1B 30 30 N	Nickel
		65	30	35	TK1B 30 35 L	Brass	MK1B 30 35 N	Nickel
		70	35	35	TK1B 35 35 L	Brass	MK1B 35 35 N	Nickel
		70	40	30	TK1B 40 30 L	Brass	MK1B 40 30 N	Nickel
		80	30	50	TK1B 30 50 L	Brass	MK1B 30 50 N	Nickel
		80	40	40	TK1B 40 40 L	Brass	MK1B 40 40 N	Nickel
		85	35	50	TK1B 35 50 L	Brass	MK1B 35 50 N	Nickel
		90	30	30	TK1BTB3030L	Brass	MK1BTB3030N	Nickel
		90	35	30	TK1BTB3530L	Brass	MK1BTB3530N	Nickel



* To process "master keyed" and "key alike" orders add either AM or KA in each part number, respectively.

** The butler system lets operate with the key form the outside even if knob is blocked from the inside. Is a solution thought for schools, geriatrics..etc.

TESA Master key systems

A master key system is a planned locking system where a master key can open more than one cylinder, even if each cylinder has its own key. For offices, residential homes and blocks of various floors, the master key system is the immediate solution that allows to establish an access control while reducing the number of keys that must be handled: security and comfort.

Central locking system.
(Community type)

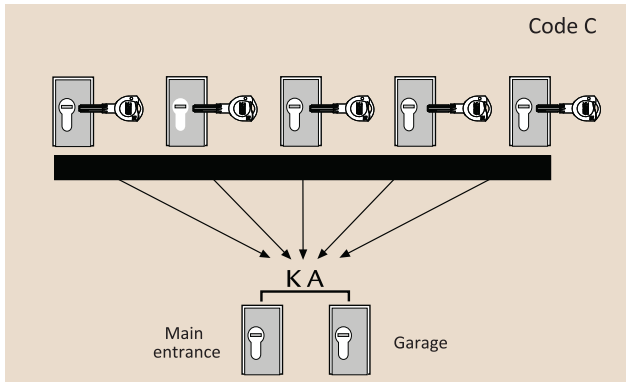

Central locking system with master key.
(Company type)

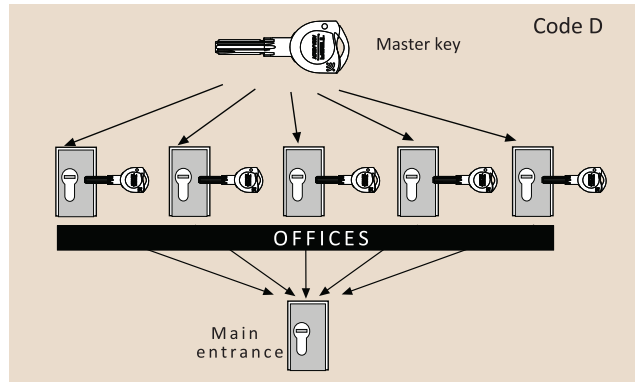

Central locking with several levels.
(Apartment blocks type)

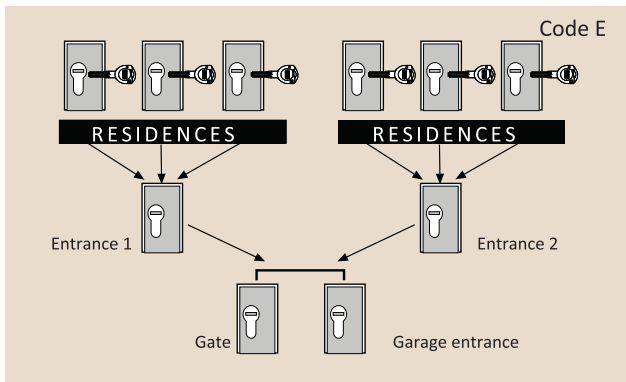

Simple master key suite.

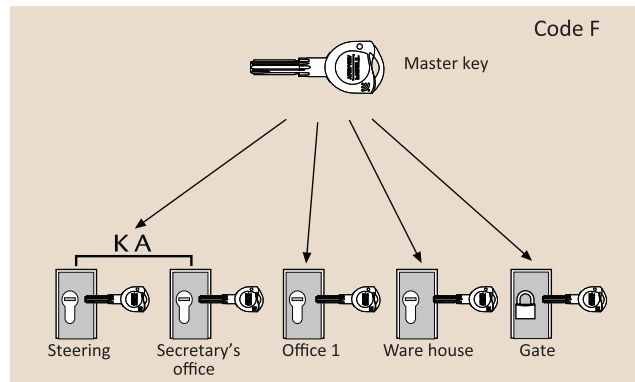

Group master key suite.
(Hotel type)

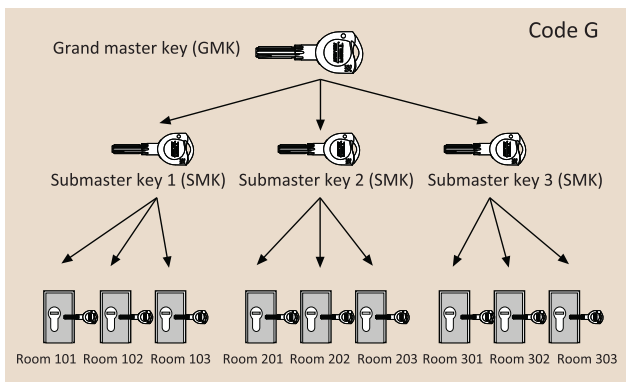

Complex master key system
(Company type)

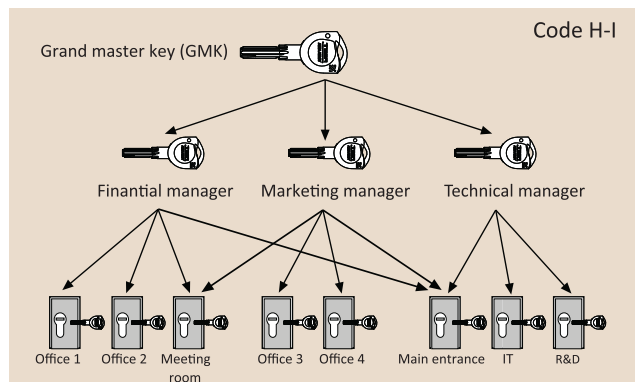

AGB CYLINDERS

MADE OF ITALY



01-NATURALE / PLAIN.....

08-SATINATO / SATIN.....

10-VERNICIATO / ENAMELLED.....

12-OTTONATO ANTICO LUCIDO / ANTIQUE BRASS GLOSSY.....

72-OTTONATO ANTICO OPACO / ANTIQUE BRASS MATT.....

02-BRONZATO / BRONZE PLATED.....

06-NICHELATO LUCIDO / NICKEL PLATED.....

16-NICHELATO OPACO / MATT NICKEL PLATED.....

34-CROMATO OPACO / MATT CHROMIUM PLATED.....

32-CROMATO SATINATO / SATIN CHROMIUM PLATED.....

13-NICHELATO SATINATO / SATIN NICKEL PLATED.....

F9-TITANIO NERO LUCIDO / GLOSSY BLACK TITAN.....

























84- NERO OPACO / MATT BLACK.....

FORTRESS LAND

Introducing AGB Cylinders

Mod 600

Cylinder with profiled key

Antiburglar						
Systems						
Duration						
Finish						



Strict tests have been done in the Research & Development Laboratory to check the characteristics according with the regulation EN 1303.

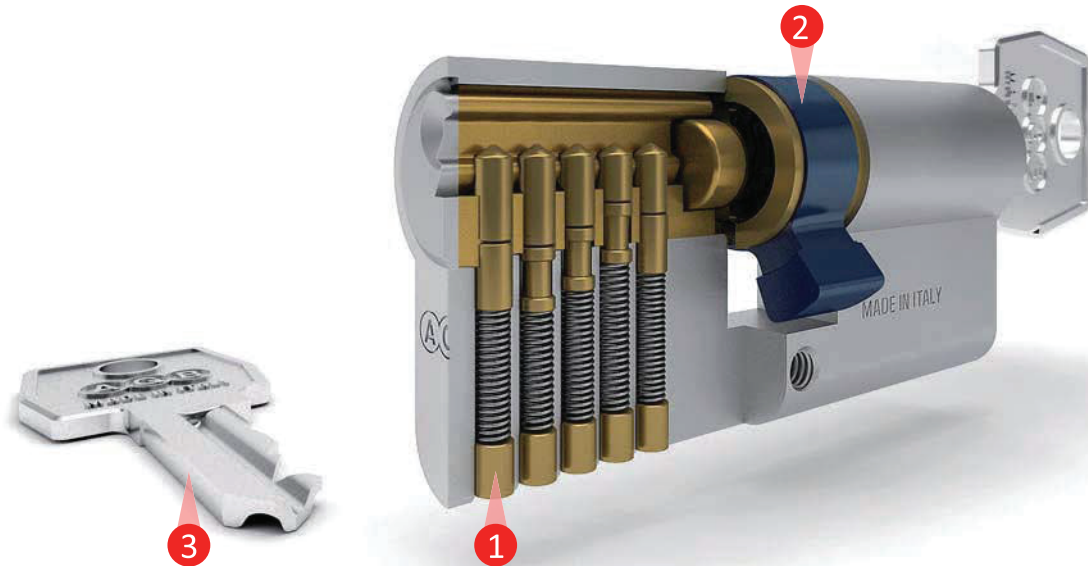

- 4 or 5 pins in brass for the coding. **1**
- Version with 6 pins for coding is available.
- Anti-pull cam in sintered steel. **2**
- 3 profiled keys. **3**
- Wide possibility of existing coding
- Suitable for fire and smoke resistant doors.

Standard Finishes:

01 PLAIN	34 MATT CHROMIUM PLATED	72 OPAQUE ANTIQUE BRASS PLATED
